

HET

MANAGING ONTOLOGIES AND LEXICAL RESOURCES

8TH INTERNATIONAL CONFERENCE ON
TERMINOLOGY AND KNOWLEDGE ENGINEERING

TKE 2008

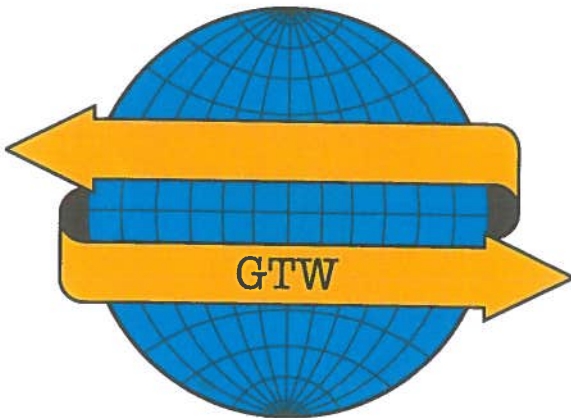

HOSTED BY
DEPARTMENT OF INTERNATIONAL LANGUAGE STUDIES AND COMPUTATIONAL
LINGUISTICS
COPENHAGEN BUSINESS SCHOOL



Contents

Organizing and Program Committees, Local Organizers	2
Practical information	3
• Conference desk, opening hours etc.	3
• Conference rooms, Lunch and Coffee Breaks	3
• Internet Access	3
• Advice for speakers	4
• Conference dinner	4
• Visit the Tivoli Garden!	4
Pre-conference workshop	5
Main Conference Program	
• Tuesday, 19.08.2008	6
• Wednesday, 20.08.2008	8
Post-conference workshop	10
Overview of the Building on Dalgas Have 15	
• Ground Floor	12
• 1 st Floor	14

William 3815 3667
 Jan Helme 3088

Organizing Committee

Klaus-Dirk Schmitz, Fachhochschule Köln, Cologne

Christian Galinski, Infoterm, Vienna

Bodil Nistrup Madsen, Copenhagen Business School, Denmark

Hanne Erdman Thomsen, Copenhagen Business School, Denmark

Program Committee

Anita Nuopponen FI

Jae Sung Lee KR

Annelise Grinsted DK

Johan Myking NO

Bassey Antia NG

Kara Warburton CA

Birthe Toft DK

Khurshid Ahmad UK

Bodil Nistrup Madsen DK

Kiril Simov BG

Bolette S. Pedersen DK

Klaus-Dirk Schmitz DE

Changqing Zhou CN

Laurent Romary FR

Frieda Steurs NL

Lise Mourier DK

Gerhard Budin AU

Lotte Weilgaard DK

Gerhard Heyer DE

Magnar Brekke NO

Hanne Erdman Thomsen DK

Maria Teresa Cabré ES

Håvard Hjulstad NO

Marie-Claude L'Homme CA

Claudia Dobrina SE

Nelida Chan CA

Hendrick Kockaert BE

Peter Sandrini AU

Henrik Køhler Simonsen DK

Rute Costa PT

Heribert Picht DK/DE

Sun Maosong CN

Local Organizers

Bodil Nistrup Madsen, bnm.isv@cbs.dk

Hanne Erdman Thomsen, het.isv@cbs.dk

Henrik Køhler Simonsen, hks.isv@cbs.dk

Research Group for Terminology, Lexicography & LSP

Communication, [Department of International Language Studies and Computational Linguistics](#), Copenhagen Business School, Denmark

Practical Information

Conference Desk

The conference desk is situated in the entrance hall in the center of the ground floor. Opening hours are the following:

Monday	12.00 -16.00	Payment	12.00 - 13.00
Tuesday	8.30 -17.30	Payment	8.00 -11.00
Wednesday	8.30 -17.30		
Thursday	8.30 -17.30		

The registration fee must be paid during the time slots indicated above.

Conference Rooms, Lunch and Coffee Breaks

Workshop Monday:	1 st floor 1Ø001
Conference Tuesday:	ground floor SC033 and 1 st floor 1Ø001
Conference Wednesday:	ground floor SC033 and 1 st floor 1Ø001
Workshops Thursday:	1 st floor 1Ø001

Lunch: ground floor, "Faculty Club"
 Coffee breaks: Tuesday and Wednesday – outside room SC033
 Monday and Thursday – outside room 1Ø001

Internet Access

Computers on-line for TKE-participants can be found in rooms 1C003 and 1C009 (1st floor) from 9.00 to 18.00 Monday to Thursday:

Login: ~~TKE2005~~
 Password: ~~TKE_2005~~

Username tke2008.isv
 password TKE_2008
 Log on to HHK

The wireless network at CBS covers large parts of the public areas at Dalgas Have. When starting your PC choose CBS-WLAN as the wireless network and identify yourself:

User name: TKE08@CBS.dk
 Password: DH-August34

Advice for Speakers

In the program there is a slot of 45 minutes for each paper. Your presentation should, however, not exceed 30 minutes. In this way 10 minutes are left for questions and discussion and 5 minutes for switching between presentations or for changing room.

Please use the PC available in the room, which is connected to a projector. PowerPoint presentations should be prepared while using the screen resolution 1024 by 768 pixels. Your presentation file should be copied from a USB memory stick to the PC beforehand, thus avoiding any loss of time during the session.

Therefore, we kindly ask you to contact the chair person in the presentation room during the break preceding the session (at least 10 minutes before start of the session) in order to provide him/her with the file of the presentation.

Conference Dinner

Danish Design Center, Tuesday 19 August, 19.00.

The Danish design center is located at H.C. Andersens Boulevard 27, (opposite to Carlsberg Glyptotek), see the map on p.11 of this leaflet. Enjoy a nice evening with good food and wine!

Price: DKK 650

Dress: Informal

Visit the Tivoli Garden!

The conference badge gives free access to the amusement park Tivoli (see the map on p.11 of this leaflet) during the conference 18-21 of August.

Pre-conference workshop

(check the workshop home page at <http://www.ttt.org/tke2008/> for the latest updates)

Title Walking across the Application Divide between Mainstream Terminological Resources and the Semantic Web: Mining Information in TBX for Use in SKOS and OWL Environments

Date 18 August 2008 from 12.30 to 17.00

Room 1Ø001

Schedule

The workshop will begin at 12.30 and run until 17.00. The projected, approximate schedule is as follows:

<u>Mission Elapsed Time</u>	Talk
12.30	Introduction
12.40	Term-enhanced Search
13.00	TBX Tutorial
13.30	(break)
14.00	TBX-SKOS Mapping
14.30	OWL Tutorial
15.00	Pouring information into OWL
15.20	(break)
15.50	Design Session
17.00	(end)

TKE 2008 - Final programme of the main conference

19.8

9.15

Dalgas Have SC033		
Welcome		
Invited Speaker: Aldo Gangemi		
LMM: A Semiotic Meta-model for Interoperability of Heterogeneous Knowledge		
Chair: Klaus-Dirk Schmitz		
Coffee		Coffee
Dalgas Have SC033		Dalgas Have 10001
Ontologies and Concept Systems		Terminology Extraction
Chair: Bodil Nistrup Madsen		Chair: Florian Holz
Suarez-Figueroa, Gomez-Perez:		Marshman, L'Homme, Surtees:
First Attempt towards a Standard Glossary of Ontology Engineering Terminology		Verbal Markers of Cause-Effect Relations across Corpora
Nuopponen:		Halskov, Barriere:
Causal Concept Systems		Building a Specialized Ontology: Why Go on the Web?
Lunch		Lunch
Chair: Birthe Toft		Chair: Tine Lassen
De Baer, Kerremans, Temmerman:		Drouin, Doll:
Constructing Ontological-underpinned Terminological Resources: a Categorisation Framework API		Quantifying Termhood through Corpus Comparison
Huckstorf:		Balahur, Montoyo:
The Multilingual European Thesaurus on International Relations and Area Studies: an Example of Successful European Terminology Co-operation		An Incremental Multilingual Approach to Forming a Culture Dependent Emotion Triggers Lexical Database
Coffee		Coffee
Chair: Birthe Toft		Chair: Aurélie Picton
Sambre, Wermuth:		Bulskov, Andreasen, Terney:
A UML Causal Ontology for Medical Instrumentality		Ontological Summaries
		Holz:
		Semantic Structuring of Document Collections and Building of Term Hierarchies: an Unsupervised and Knowledge-free Approach
Conference Dinner		

9.30

9.45

10.00

10.15

10.30

10.45

11.00

11.15

11.30

11.45

12.00

12.15

12.30

12.45

13.00

13.15

13.30

13.45

14.00

14.15

14.30

14.45

15.00

15.15

15.30

15.45

16.00

16.15

16.30

16.45

17.00

...

18.00

18.15

18.30

18.45

19.00

	Dalgas Have SC033	Dalgas Have 1Ø001
	Ontologies and Concept Systems	Terminology Extraction
	Chair: Aldo Gangemi	Chair: Patrick Drouin
9.00	Toft:	Picton:
9.15	Initial Delimitation of Domains and Initial Conceptual Modelling: Can General	Combining Clues to Explore Knowledge Evolution in Texts
9.30	Guidelines Be Devised?	
9.45	Blaise, Dudek:	Marshman, van Bolderen
10.00	Terminology Analysis Inspires Relations in a Knowledge Structure: an	Interlinguistic Variation and Lexical Knowledge Pattern: Comparing Data English
10.15	Experiment on the Vocabulary of Heritage Architecture	and French
10.30	Coffee	Coffee
10.45		
	Ontologies and Concept Systems	Terminology Policies and Language Management
	Chair: Anita Nuopponen	Chair: Annelise Grinsted
11.00	Madsen, Thomsen:	Vasiljevs, Rirdance:
11.15	Terminological Principles Used for Ontologies	Ontological Enrichment of Multilingual Terminology Databank
11.30		
11.45	Peltoniemi:	Sørensen:
12.00	Is It Possible to Study Scientific Concepts? The Way to Use Concept Analysis	Extreme Knowledge Engineering - the Intricacy of Food Label Communication
12.15	as a Research Method	
12.30	Lunch	Lunch
12.45		
13.00		
13.15		
	Metadata and Metamodels	Terminology Policies and Language Management
	Chair: Andrejs Vasiljevs	Chair: Frieda Steurs
13.30	Kemps-Snijders, Windhouwer, Wittenburg, Wright:	Klischewski, Antia:
13.45	A Revised Data Model for the ISO Data Category Registry	Language in Games Development and Localization
14.00		
14.15	Warburton:	Thomsen, Grinsted:
14.30	Recent Developments in Terminology Markup Languages and their Impacts on	Cost-benefit Analysis of the Introduction and Implementation of a Terminology
14.45	the Information Management Industry	Managment System
15.00	Coffee	Coffee
15.15		
15.30		
	Dalgas Have SC033	
15.45	Invited Speaker: Alessandro Lenci	
16.00	Lexicons and Ontologies: New Synergies for Old Challenges	
16.15		
16.30	Chair: Hanne Erdman Thomsen	
16.45	Closing of the conference	
17.00		
17.15		
17.30	GTW General Assembly	
17.45		
18.00		
18.15		
19.00		

Post-conference workshop

(check the workshop home page at http://www.microsoft.com/language/conferences/TKE2008_Workshop.htm for the latest updates)

Title Development of Enterprise-level Ontology and Lexical Resource Solutions

Date 21 August 2008

Room 1Ø001

Schedule

Time	Sessions
9:00	Introduction and Overview
9:15	<u>Terminology Management at IBM</u>
10:00 - 10:45	<u>From Dispersed Local Glossaries to a Global Terminology Management System</u>
10:45	Coffee Break
11:00	<u>Overview of Ontology Standards</u>
11:45	Open Discussion
12:00	Lunch Break
13:30 - 14:45	<u>From Terminology to Ontology - Process and Skills Implications</u>
14:45 - 15:30	<u>Challenges for Terminology and Ontology Management</u>
15:30	Coffee Break
15:45 - 16:20	<u>The First Step from Terminology to Ontology with NLP (Natural Language Processing) Technologies</u>
16:20	Open Discussion

Location of the Danish Design Center and the Tivoli Garden

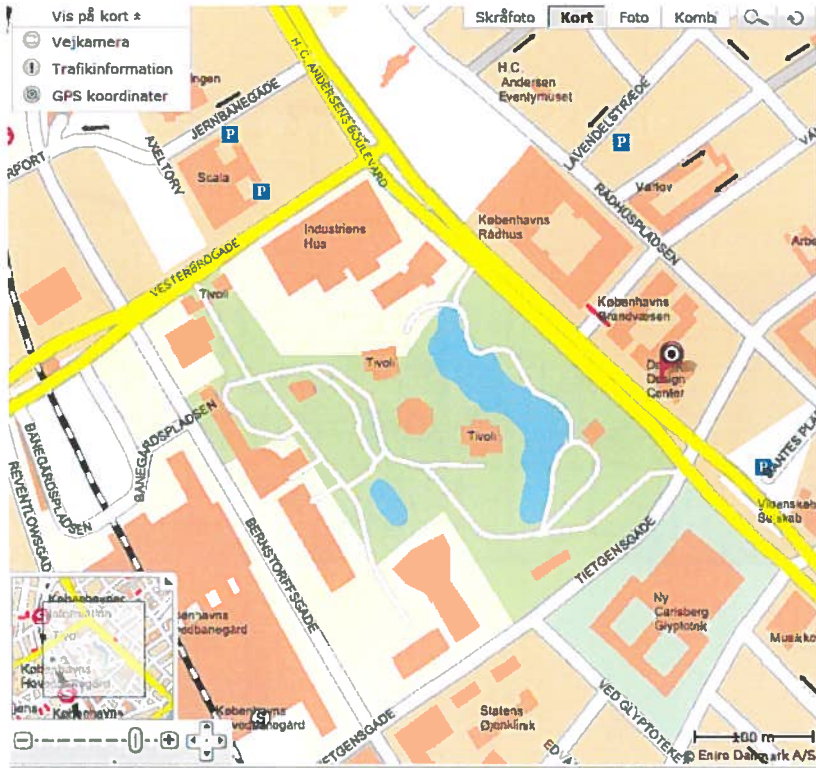

Handelshøjskolen i København
Copenhagen Business School
 Dalgas Havn 15
 2000 Frederiksberg

Stueetage / Ground Floor

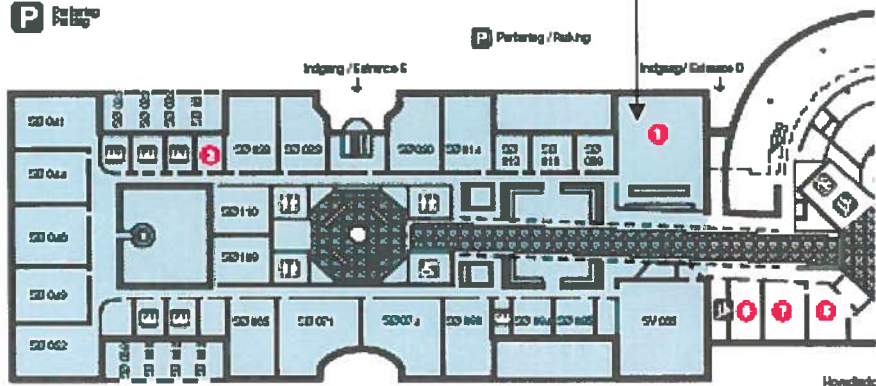

Øst / East

- 1 Faculty Club
- 2 BA-tilførselsstation

Center

- 3 Auditorium / Lecture Hall
- 4 Boghandel / Bookshop
- 5 Info service
- 6 Kopieringsrum - studenter
- 7 Kopieringsrum - ansatte /

Køleser / Cooler



2007 & 5 = STUEN / GROUND FLOOR, Ø = ØST / EAST, #7# = LOKALNUMMER / ROOM NUMBER

Toilets are found around the building and in the basement under the center hall where the conference desk is located.

Conference room **SC033**

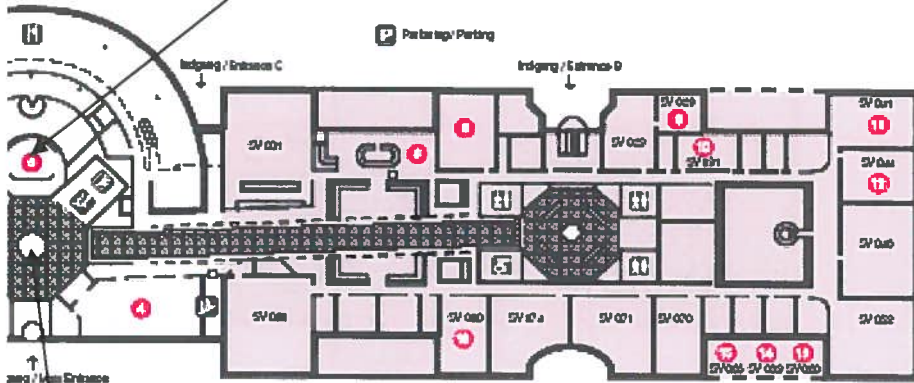

West / West

- 0 Café La Caba, DSR
- 9 CAME - Center for Applied Management Studies
- 10 HMC - Handeltshulsholen Eilett und Lernabscenre / Center for Continuing Education
- 11 CE 2 Executive
- 12 MBA - Programms
- 13 MCC - Master of Corporate Communication
- 14 MSL - Master in Shipping and Logistics
- 15 M&D - Master of Management Development
- 16 M&H - Master of Health Management / MBA - Master of Public Administration

Registration desk

Handelshøjskolen i København
Copenhagen Business School
 Dalgas Have 15
 2000 Frederiksberg

1. sal / First Floor



Conference and
workshop room **10001**

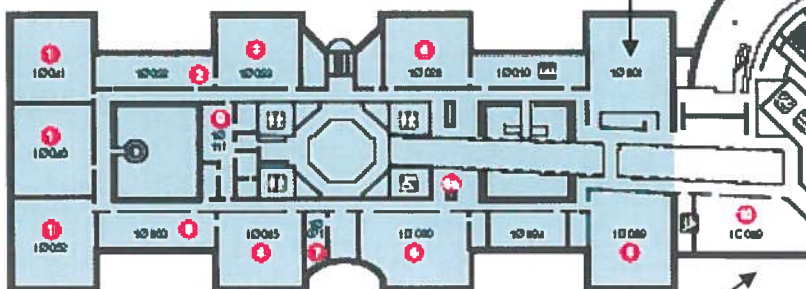

Øst / East

- 1 Tølbæres / Mail sorting room
- 2 CBS IT
- 3 Sproglabestuer / Language Lab
- 4 Sproglabestuer / Language Lab
- 5 B-undervisningsrum / IT classrooms
- 6 B-undervisnings / 2. leders computer room
- 7 B-vejleder / Global IT-supporters
- 8 Elektronisk Studie-Center / Electronic study centre
- 9 AH-afdeling / CBS IT - AH Department
- aa Indtår

Center

10 B-undervisningsrum

Computer room
1C009

1012101.SAL/FIRSTFLOOR.V. VEST/VEST.014 014 LOKALENUMMER / ROOM NUMBER

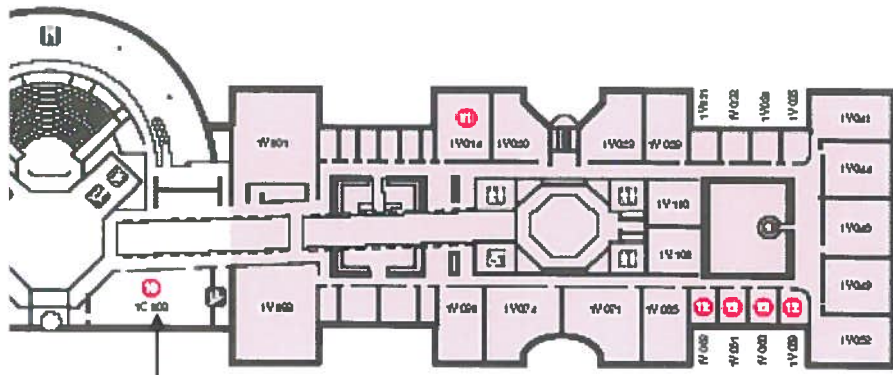

IT classroom

West / West

- 11 Knowledge / The CBS Canal
- 12 Center of Market Economics
- 13 CSIT

Computer room
1C003

Notes

Sponsors:



**Copenhagen
Business School**
HANDELSHØJSKOLEN

Terminet
International Network for Terminology



The Danish Society for the Advancement of Business Education

